



---

Dear Customer,

**PLEASE NOTE THE FOLLOWING INFORMATION:**

Enclosed is the **Gas and/or Electric** information you requested within the subject area. **Please use these maps to confirm the location of PG&E facilities shown on your plans.**







These electronic files contain information that is proprietary and/or confidential information of Pacific Gas and Electric Company and is **intended for use only by authorized persons**. Unless specifically authorized to do so, do not make copies of these files, or distribute it to anyone other than persons authorized to use these files.

Before you start any trenching on your project, please call **Underground Service Alert (USA) at 811** at least 48 hours prior to any excavation, to have your work area marked for underground facilities. Call USA (811) to obtain exact location of facilities and pot-hole to verify depth of our lines (if required). Please note that a standby PG&E employee is required during any excavation within **10 feet** of a **gas transmission line**.

**If you discover a conflict or if you determine our facilities need to be lowered/raised, please contact your PG&E Representative, file an application online at [www.pge.com/customerconnections](http://www.pge.com/customerconnections), or call 877-743-7782.**

PG&E does not provide depth information about our existing electric and gas facilities (i.e gas main and services, etc). Underground facilities are **generally** 24" to 36" deep. However, the depths may have changed due to street reconstruction and general area changes. If, after receiving our maps, you determine depth information is needed to better plan future street improvements, you should pothole or take appropriate action as needed.

Controllable Fittings	Transition Indicator	Main Job Separator	Transition Indicator	Main Job Separator	Transition Indicator	Main Job Separator	Transition Indicator	Main Job Separator
	No	No	Yes	No	No	Yes	Yes	Yes
Bottom Tap								
Bottom Tap TDW								
Half Line Stopper								
Half Line Stopper TDW								
Line Tap / Double Line Tap								
Line Stopper								
Line Stopper TDW								
Pin-Off Tee								
High Volume Punch Tee / Service Tee								
Punch Tee								
Side Tap								
Side Tap TDW								
Spherical Tee								
Spherical Tee TDW								
Top Tap								
Top Tap TDW								

Regulator Station		Above Ground Indicator	Reliever Indicator	Above Ground Indicator	Reliever Indicator	Above Ground Indicator	Reliever Indicator	Above Ground Indicator	Reliever Indicator
		No	No	No	Yes	Yes	No	Yes	Yes
District Regulator									
Low Pressure Regulator									
High Pressure Regulator									
	Yes	Above Ground Indicator					No		
System Relief Station									
	Meter Station								

Customer Regulator	
	High Pressure Regulator
	Service Regulator

NonControllable Fittings		
Trans/Dist		Service
	Branch Saddle	
	Clamp	
	Coupling	
	Cross	
	Elbow	
	End Cap	N/A
	Expansion Loop	
	Flange	
	In-Line Expansion Joint	
	Insulating Joint	
	Mechanical Joint	
	Mechanical Expansion Coupling	
	Mechanical Insulated Transition Coupling	
	Mechanical Transition Coupling	
	Reducer	
	Riser	
	Sleeve	
	Tee	
	Temporary Cast Iron End Cap	
	Transition	
	Transition Reducer	
	Wedding Band	

Gas Valve		
Open		Closed
	Valve	
	Insulated	
	Frame & Cover	
	Frame & Cover Insulated	
Left	Check Valve	Right
	Flow	
	Flow Insulated	
	Service Excess Flow Valve	

Active Leaks			
	Grade 0		Grade 2
	Grade 1		Grade 3
	Grade 2+		Repaired, Recheck
Inactive Leaks			
	Repaired		Cancelled

Linear Symbology		
Service Lines		
	Cast Iron	
	Plastic	
	Tenite	
	Non-Locatable Stub	
	Cast Iron, Pre-Posted	
	Plastic, Pre-Posted	
	Tenite, Pre-Posted	
Distribution Mains		
	High Pressure	
	Semi High Pressure	
	Low Pressure	
	High Pressure, Pre-Posted	
	Semi High Pressure, Pre-Posted	
	Low Pressure, Pre-Posted	
Transmission Mains		
	Numbered and Unnumbered	
	Pre-Posted	
Deactivated Pipeline		
	Vent Line	
	High Consequence Area	

Pipeline Casing	
	No Vents
	One Vent Left
	One Vent Right
	Two Vents
	Sensing Line

SCADA Devices	
	Auto Meter Reading
	Remote Control Operation
	Remote Pipe to Soil
	Remote Rectifier
	SCADA Information Only
	Telemeter

Service Tap	
	Branch Saddle
	Bottom Tap
	Coupling
	Cross
	High Volume Punch Tee
	Pin-Off Tee
	Punch Tee
	Reducer
	Service Tap
	Service Tee
	Side Tap
	Spherical Tee
	Tee
	Top Tap

Service Location	
	Above Standard Delivery
	Curb Meter Indicator
	Service Stub End Cap
	Standard

Public Assembly	
	Confirmed
	Not Confirmed

Pipeline Markers	
	Aerial
	Aerial Horizontal
	Carsonite
	DAS Marker
	Electronic Marker
	Orange Post
	River or Bay
	Stake Or Pipe
	Surface Adhesive Sticker
	Water Crossing Sign
	WIG-WAG



Pacific Gas and Electric Company

GD GIS  
Release Date: 2/29/16

# Gas Symbology

Instruments	
	Electronic Recorder
	Mechanical Recorder

Conversion Flags	
	DC PAR Flag
	DC Error Flag

Miscellaneous Structures	
	Foreign Structure
	Station Structure
	Vault

Miscellaneous Features	
	Atmospheric Corrosion
	Block Break
	Blow Off
	Compressor
	Drip
	Electric Substation
	Filter
	Foreign Device
	Gas Lamp
	Gas Well (active)
	Gas Well (inactive)
	Holder (no compressor)
	Holder (with compressor)
	Job Separator
	Odorizer
	Squeeze Point
	Underground Gas Storage

Cathodic Protection	
Rectifier	
	Below Ground
	In Pedestal
	Panel Mount
	Pole Mount
Test Point	
	Corrosometer Probe – Above Ground
	Corrosometer Probe – Below Ground
	Coupon – Above Ground
	Coupon – Below Ground
	ETS – Above Ground
	ETS – Below Ground
	Monitoring Point (All Types)
	Service Riser
	Anode
	Bond
CP Linear Symbology	
	CP Functional Line
	CP Wire

Critical Facilities	
	Critical Facilities Point
	Critical Facilities Line
	Critical Facilities Polygon
Boundary Features	
	Emergency Isolation Zone
	Leak Survey Grid
	Leak Survey Area
	Therm Billing Area
	Cathodic Protection Area
Pre-Post Polygons	
Invisible	Cancelled due to SAP

Miscellaneous Lines	
	Locating Wire
	Gas Pipe Duct
Foreign Line	
	Electric
	Fences
	Fiber
	Gas
	Other
	Plates
	Telephone
	Unknown
	Wastewater
	Water

Landbase Layers	
Street Name Labels	
TeleAtlas Street Centerlines	
PG&E Temporary Streetnames	
	Access Road
	City
	Lot Lines
	PG&E Easement
	PG&E Right Of Way
	Private Road
	Railways
	Stream
	Water Polygon
*These layers are just a representation of some of the Landbase layers.	



## Other Symbology Changes

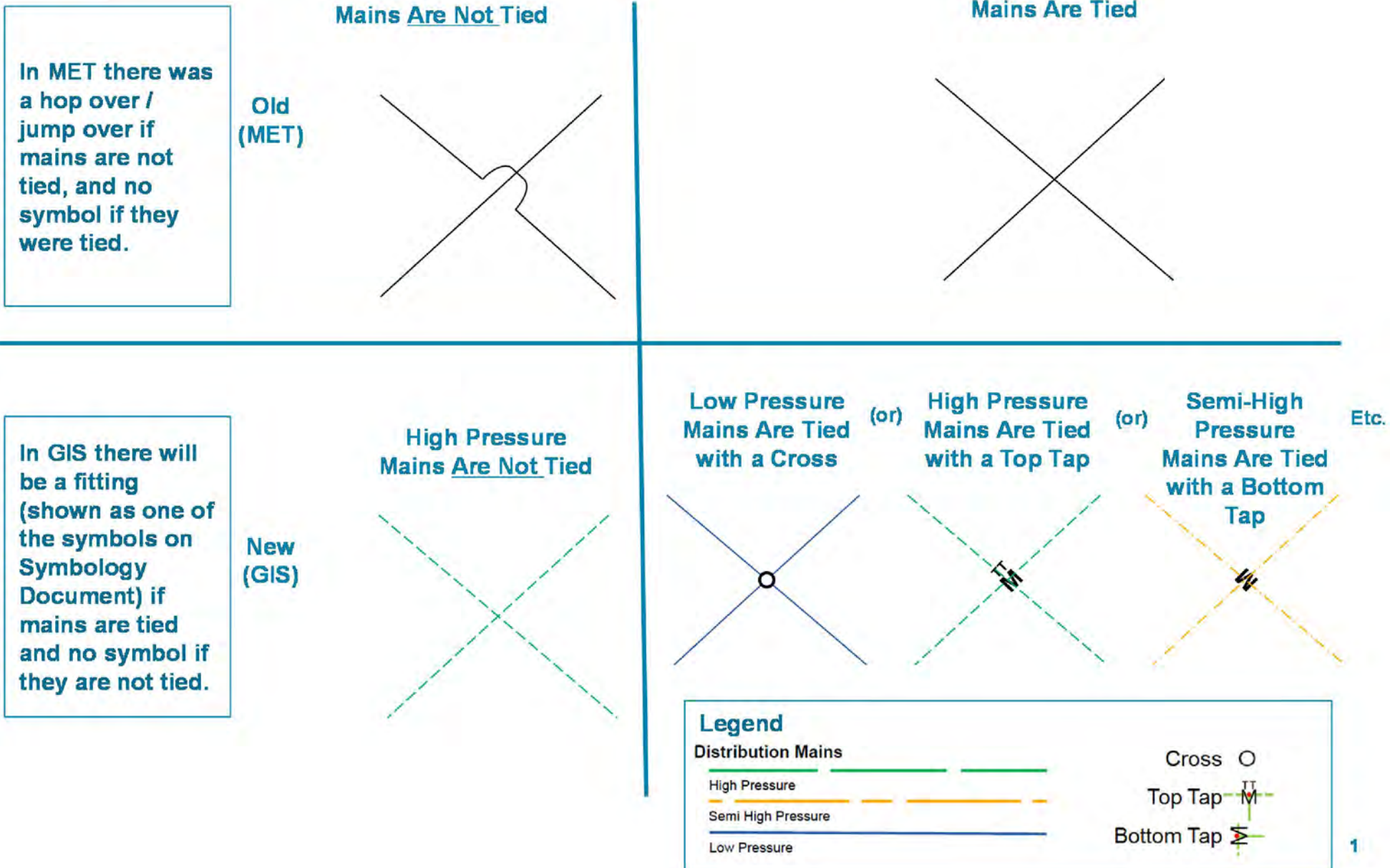



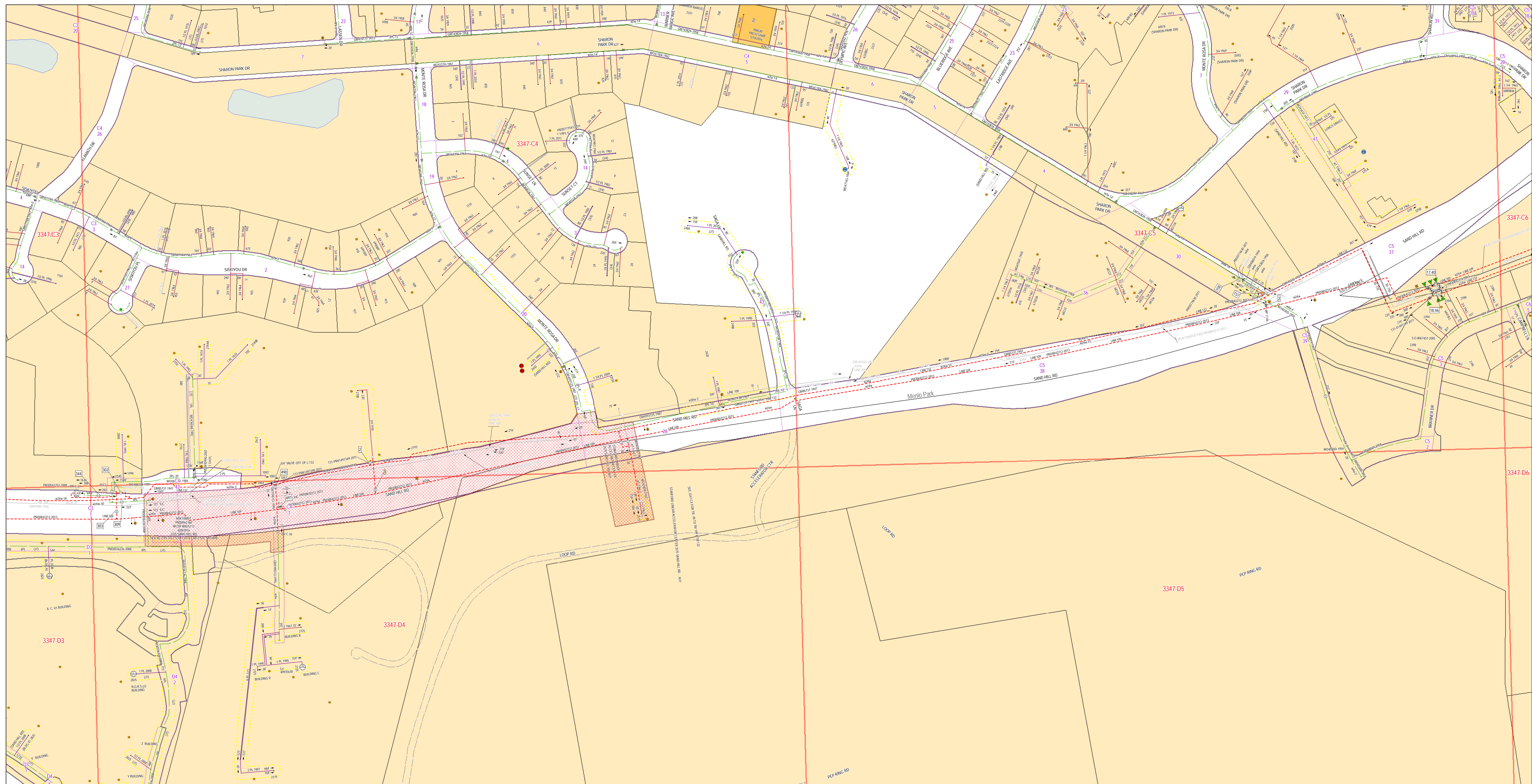

# Pacific Gas and Electric Company

## Sand Hill Rd, Menlo Park - Map 2

IF YOU DISCOVER A CONFLICT OR IF YOU DETERMINE OUR FACILITIES NEED TO BE LOWERED/RAISED, FILE AN APPLICATION ONLINE AT [WWW.PGE.COM/CUSTOMERCONNECTIONS](http://WWW.PGE.COM/CUSTOMERCONNECTIONS) OR CALL: (877) 743-7782.

APPROXIMATE LOCATIONS  
VERIFY BY HAND TOOLS  
PACIFIC GAS AND ELECTRIC CO.

"WARNING: Confidential, Proprietary Information  
This document contains confidential, proprietary information that is the sole property of Pacific Gas and Electric Company (PG&E) and is intended for use only by authorized PG&E employees and agents.  
Copyright Pacific Gas and Electric Company 2016"

PLEASE CALL U.S.A. AT  
LEAST 48 HOURS PRIOR TO  
EXCAVATING IN THIS AREA  
Dial 811

THIS MAP IS FOR THE EXCLUSIVE USE OF Freyer & Laureta, Inc ONLY. IT IS NOT TO BE REPRODUCED AND DISTRIBUTED TO OTHERS WITHOUT WRITTEN PERMISSION FROM PG&E

